

3 Bedroom, 2 Full Baths

1,027.5 square feet

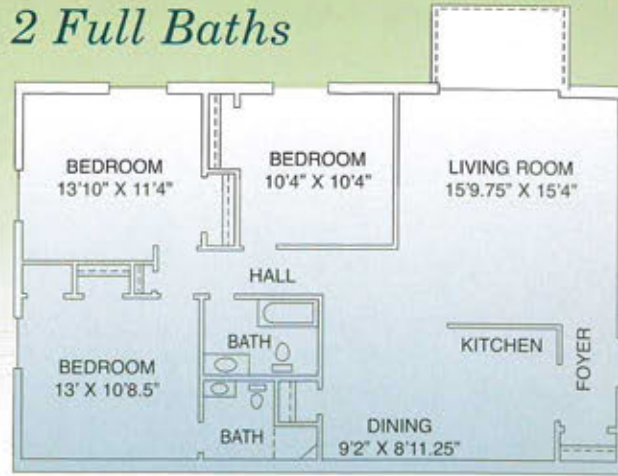

\$ Month

2 Bedroom, 1 1/2 Bath

879.5 square feet



\$ Month

2 Bedroom, 1 Bath

841.5 square feet



\$ Month

Dimensions may vary slightly in each unit.

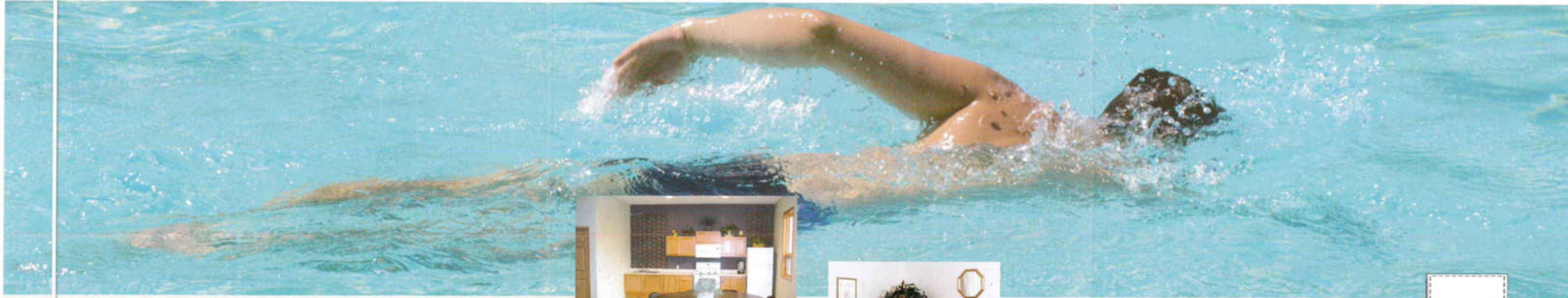

Imagine living without the pressures of lawn care or maintaining a house. All day long, you can play in the indoor or outdoor pools or the complete fitness center. Maybe you'd just like to read a book by the fireplace in the Welcome Center or take a walk in the park. *It's all here for you with luxury living at Stadium View Apartments.*



1 Bedroom

560.5 square feet

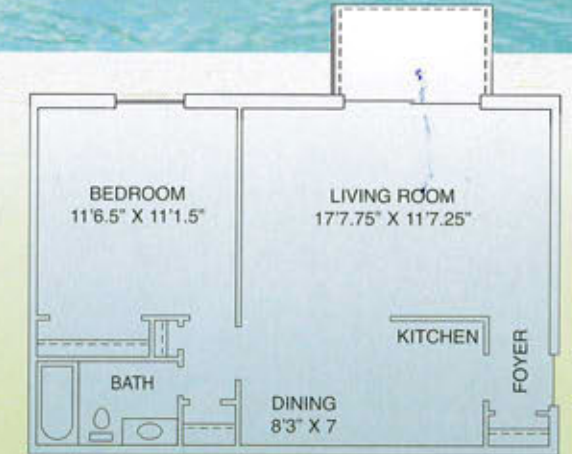

\$ Month

A place to live and a place to enjoy life.

You're invited to tour our apartment homes, visit with our residents, and explore the recreational and cultural options that are available here, downtown, and at the nearby Bowling Green State University campus. Ask at the office for a current listing of events.



*You'll find living at **Stadium View Apartments** to be a pleasant and luxurious experience . . . at an affordable cost.*

☎ 419-352-5088
 Fax 419-352-4625
home.woh.rr.com/sva



Professionally managed by Holley Properties Management Company, Ltd.
 Member of Chamber of Commerce, National Apartment Association,
 Ohio Apartment Association, Wood County Apartment Association

- ☛ Fitness center & activities for healthy living
- ☛ Banquet room for entertaining
- ☛ Gathering Place for intimate events
- ☛ Indoor & outdoor pools & activity rooms
- ☛ Patio or balcony
- ☛ Attractive landscaping, quiet tree-lined streets
- ☛ Residents with a green thumb can garden in the flower beds
- ☛ Pet friendly (with some restrictions)
- ☛ Entire apartment community is a no-smoking area

Stadium View Apartments



- ☛ Fenced play area
- ☛ Locked entry with intercom system
- ☛ Garage and storage units optional
- ☛ Ample parking
- ☛ Coin-operated laundry facility in each building
- ☛ One check every month includes your rent, heat, gas, water and sewer utilities
- ☛ 24-hour emergency maintenance repairs
- ☛ Firewalls surround each apartment for safety and soundproofing
- ☛ Located adjacent to Carter Park for exercise, softball games, & picnicking



*Leave the work behind.
 Come home to Stadium View Apartments.*

1700 Juniper Drive ☛ Bowling Green, OH 43402